



The Niles Guide For Great Outdoor Sound

P R E V I E W E D I T I O N

Adventures in Soundscaping

The weather's warming up, the barbecue grilles are coming out, and everyone's starting to think about outdoor entertaining. It's time to turn to Niles for everything you need to create that perfect outdoor sound system. Our class-leading OS Indoor/Outdoor Series and versatile Rock and Planter

loudspeakers cover virtually every application, are built for years of trouble-free use, and feature the peace of mind that comes with our Limited Lifetime Warranty. Of course, Niles also makes a wide range of amplifiers, waterproof volume controls, and everything else you need to power and control a great-sounding outdoor sound system.



BLENDING HIGH FIDELITY AND ARCHITECTURE®

Design Tip #1

Position Loudspeakers Between 12' to 15' of the Listening Area

This guideline may sound simple, but it's amazing how often it's ignored. By positioning the loudspeakers between 12' (3.7m) to 15' (4.7m) of the listening area, you provide quality sound for the listeners at comfortable volume levels, without the need for huge amounts of amplifier power.

Niles OS 7.5 Outdoor Loudspeaker

A high-performance loudspeaker designed to mount on walls, in corners, and under eaves.

Niles OS 7.5 loudspeakers install quickly and exceed military anti-corrosion specifications. They feature a 7" (18 cm) interlaced carbon fiber woofer for tight, rich bass and a 1" Teteron tweeter for smooth, detailed highs. Available in white or black.

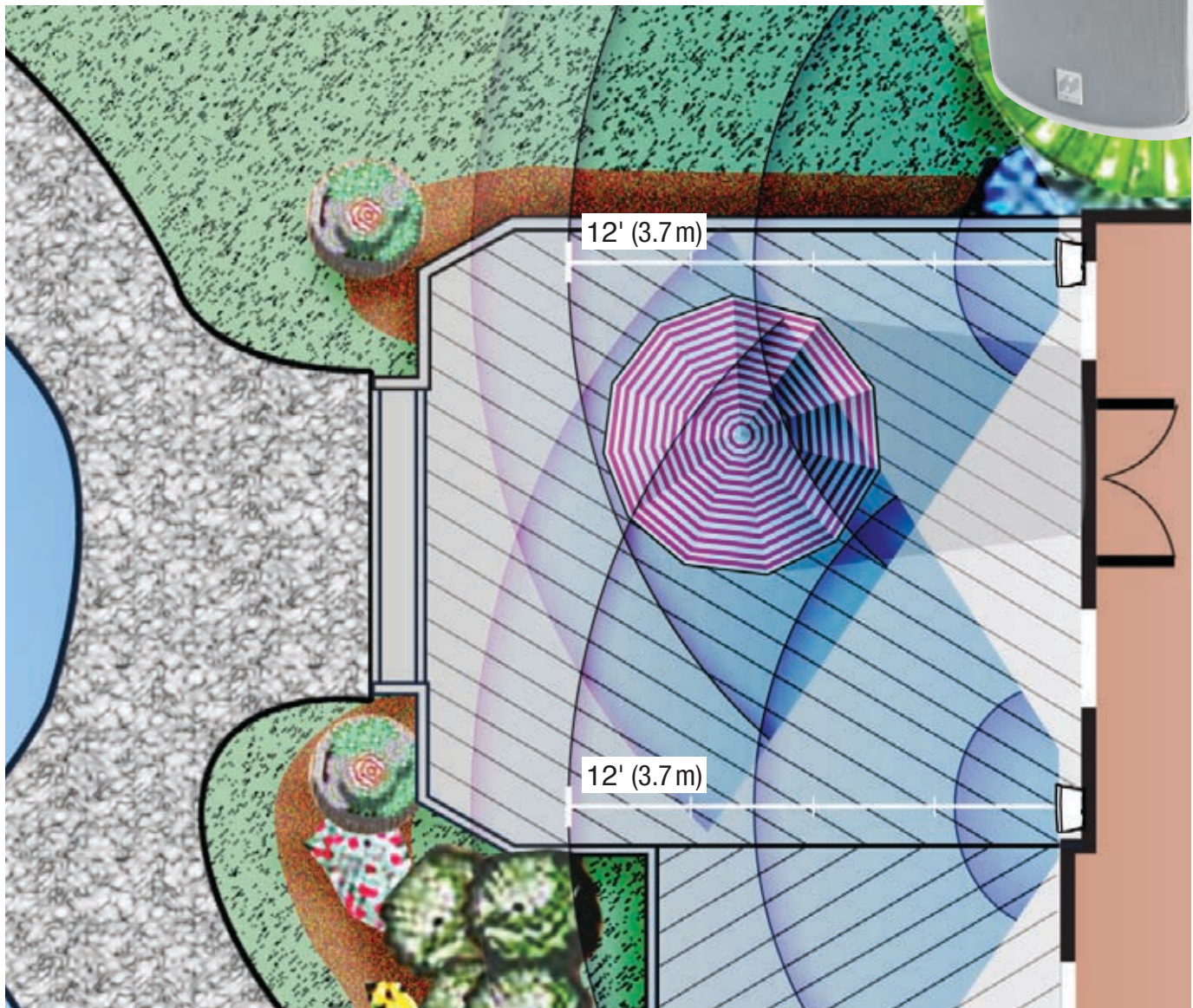

In this illustration, the primary listening area is the table on the deck. To ensure good sound for the listeners, we're using a pair of Niles OS

loudspeakers on the wall approximately 12' away. Another option would be a couple of Niles Planters along the wall or along the side of the deck.

Design Tip #2

More Loudspeakers Are Better Than More Power

When you have an oversized or a particularly large outdoor area, it's always better to add more loudspeakers than more power. In this Design Tip we'll start with the same listening area from Design Tip #1, but now we'll add a pool area that's 30' (9m) away. You could just boost the amplifier power so the patio speakers play loud enough to reach the pool, but that would just blast the ears of our listeners at the table.

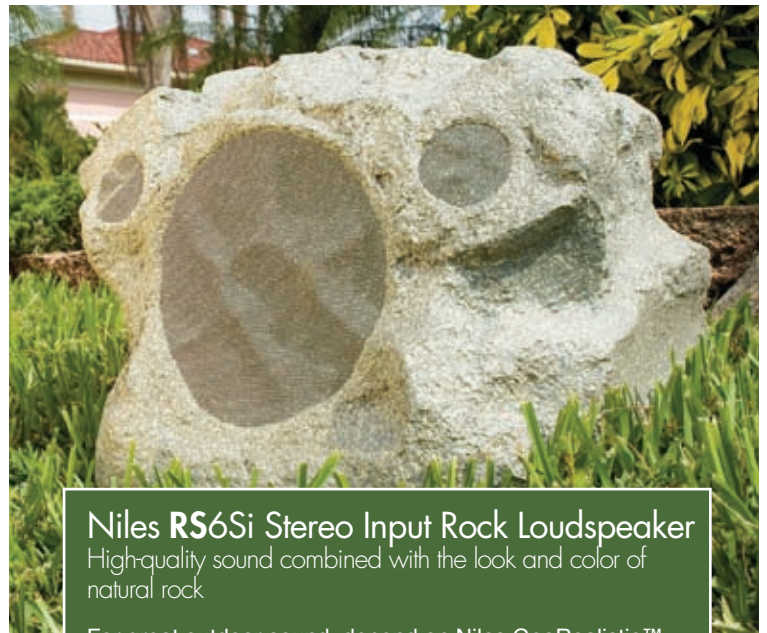

Niles RS6Si Stereo Input Rock Loudspeaker

High-quality sound combined with the look and color of natural rock

For great outdoor sound, depend on Niles GeoRealistic™ loudspeakers. The RS6Si produces stereo sound from a single cabinet, features a Limited Lifetime Warranty, and comes in a variety of finishes: speckled granite, granite, coral, sandstone, and shale brown.

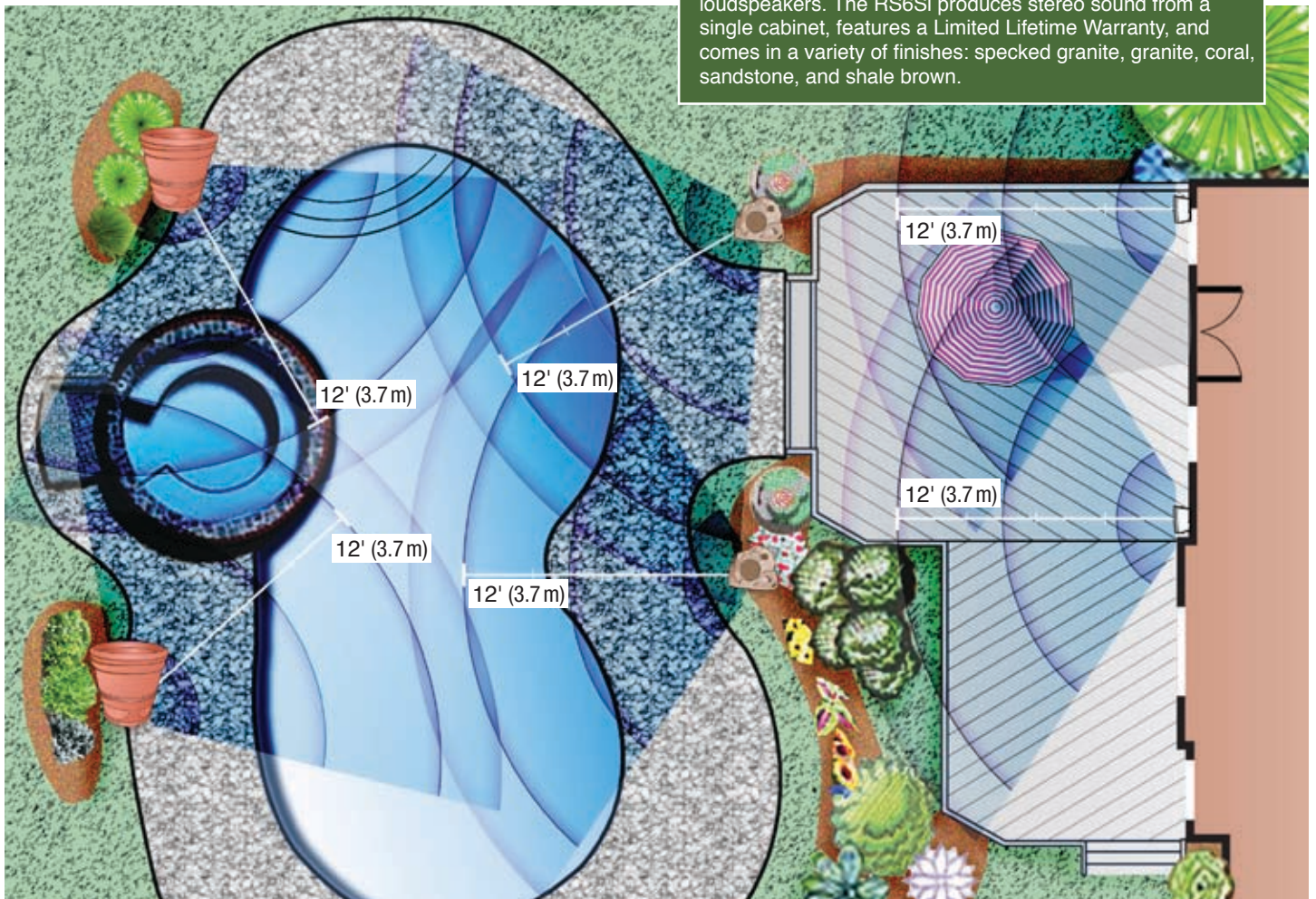

The solution is more loudspeakers, not more power. In this illustration, we added a pair of Niles GeoRealistic™ rock loudspeakers and a pair of Niles Planters hidden in the landscaping, located approximately 12' (3.7m) from the pool. Now, the

guests sitting at the table can enjoy music at a comfortable volume level, while everyone in the pool also gets just the right amount of sound. Everyone's happy and the party rocks.

Design Tip #3

Provide Volume Controls for Each Listening Area

Ideally, each listening area should be equipped with a way to adjust the volume. A volume control or keypad in each listening area will do just that. You want the people sitting at the table to be able to adjust their music to a comfortable level, while allowing the swimmers in the pool to enjoy their music at their preferred volume level.

A weather-resistant zone keypad is the ideal volume control for outdoor areas using a ZR-6 multizone receiver with one primary listening area. A Niles Solo-6IR or Solo-6MD keypad would be an excellent choice. To ensure sufficient volume levels, a Two-Channel Niles System Integration Amplifier® connected to the zone preamp output is highly recommended.



PS6Si Planter Loudspeaker

Weatherproof outdoor loudspeakers that double as actual planters

Use Niles Planter loudspeakers to combine great outdoor sound with beautiful landscaping. There are two shapes to choose from: the traditional planter plus a rectangular box shape. Available in terracotta and weathered concrete finishes.



Individual zone volume controls are the best solution for large, single zone outdoor areas with multiple listening areas. In this illustration, Niles WMVC100E Weatherproof Muting Stereo Volume Controls are positioned for easy access near the hot tub and the deck. To adequately power all these loudspeakers, a Niles SI-1260 12-Channel Systems Integration

Amplifier would do an excellent job. Of course, if your outdoor area is made up of more than one zone, a combination of the two above scenarios might be appropriate. So keep in mind the importance of volume controls. It will make the difference between a good outdoor sound system and a truly great one.